



## 2N® IP Verso

The 2N® IP Verso security intercom is configurable to your needs thanks to its modularity. It provides reliable access control and allows you to easily interface with other systems. Now also in black, with a fingerprint reader, Bluetooth module, or touch display.



Offices and office buildings  
Residential complexes  
Family houses  
Schools and campuses

State administration public buildings  
Home Automation  
Hotels

### Bluetooth technology

Get the latest technology in access systems. The Bluetooth module lets you eliminate access codes, entry cards, and key distribution.

### Touchscreen

Create an intuitive and structured contact list similar to that in your mobile phone. It is water resistant vandal resistant and easy to read even in direct sunlight.

### Camera with night vision

See who is standing in front of your door, even in total darkness. Moreover, the camera is hidden from normal view. The intruder has no clue they're being monitored.

# 2N® IP Verso

## FEATURES & BENEFITS

### Adjustable door security levels

Make use of different security modes with the 2N® Mobile Key application, which allows you to adjust the functioning distance from the Bluetooth module.

### Intuitive controls and search

The touchscreen has all the functions of a mechanical keyboard. Discover its luxury design and intuitive controls and search.

### Access control

Achieve a greater level of security for all those at its location. 2N® IP Verso makes it easy to prevent the entry of unauthorized persons.

### Modularity

The modularity of this IP Intercom allows you to configure it to your requirements. Select the specific module, accessories and configurable functions.

### SIP support with no server needed

SIP protocol support makes it easy to link the intercom with IP phones and PBX from other producers, without having to connect to the server.

### Security relay

This simple additional device prevents intrusion by detecting any unauthorized manipulation of the electronic locking system.

### Picture to email

2N® IP Verso allows you to email snapshots of the visitor captured by the camera at the time of the call.

### 2N® Remote Configuration

Save time and money for onsite support thanks to our free service. Access all your devices remotely via secured cloud connection. Fastest response to your customers requests.

## DIAGRAM

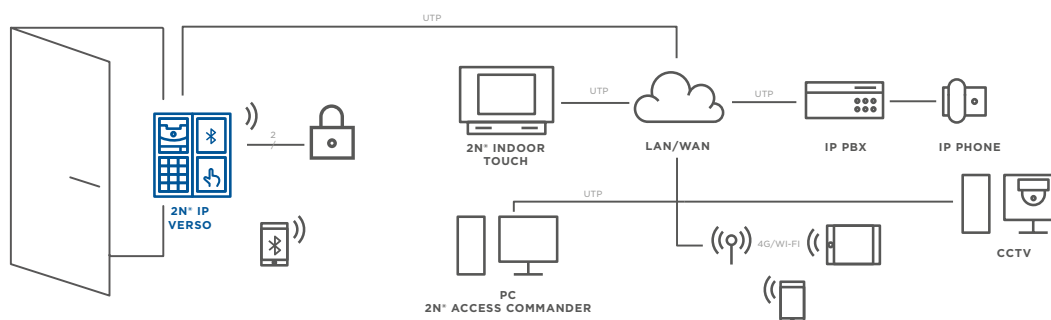

## TECHNICAL PARAMETERS

### Signalling protocol

SIP 2.0 (RFC - 3261)

### Buttons

Buttons	Transparent buttons with white backlight and easily removable label
Number of buttons	1 to 146
Numeric keypad	Optional

### Audio

Microphone	1 built-in microphone
Speaker	2W
Sound pressure at 1 kHz at 1 m distance	78 dB

### Audio stream

Codecs	G.711, G.729, G.722, L16/16kHz
--------	--------------------------------

### Camera (optional)

Resolution - JPEG	1280 x 960 px
Resolution - video call	640 x 480 px
Viewing angle	120° (H), 90° (V), 145° (D)
Night vision	Yes

### Video stream

Codecs	H.263+, H.263, H.264, MJPEG, MPEG-4
--------	-------------------------------------

### Bluetooth module (optional)

Bluetooth Smart technology	
Security	RSA-1024 and AES-128

### Touchscreen (optional)

Buttons and keyboard functions	
Operating temperature	-20°C - 60°C
Coverage level	IK07

### RFID card reader (optional)

RFID card reader	13.56MHz and 125kHz
Support for NFC	Yes, HCE and the 2N® Mobile Key application needed

### Interfaces

Power supply	12V ± 15%/ 2A DC, or PoE
PoE	PoE 802.3af (Class 0 - 12.95W)
LAN	10/100BASE-TX with Auto-MDIX, RJ-45
Switch output	NC/NO contacts, max 30 V/1 A AC/DC
Active switch output	8 to 12 V DC depending on Power supply (PoE: 10 V; adapter: source voltage minus 2 V), max 400mA
Supported protocols	SIP2.0, DHCP opt. 66, ONVIF, SMTP, 802.1x, RTSP, RTP, TFTP, HTTP, HTTPS, Syslog

### Mechanical properties

Operating temperature	-40°C - 60°C
Storage temperature	-40°C - 70°C
Operating relative humidity	10%-95% (non-condensing)
Coverage level	IP 54, IK08

### Dimensions

Dimensions depend on configuration of the modules and installation type - see [www.2n.cz](http://www.2n.cz) for details.

## SOFTWARE

**2N® Mobile Video** - mobile application providing video calls from the intercom to your mobile device

**2N® Access Commander software** - software to manage 2N IP Intercoms and access units

**2N® IP Eye** - an application that enriches your desk phone with video from the intercom camera

**2N® Network Scanner** - application for detecting 2N IP Intercoms and access control units on the network

**2N® Mobile Key** - an application that turns your mobile phone into an access card

# Modularity

MODULARITY CLARIFIED

2N® IP Verso can be tailored to your requirements. Select the specific modules, frame and mounting box.

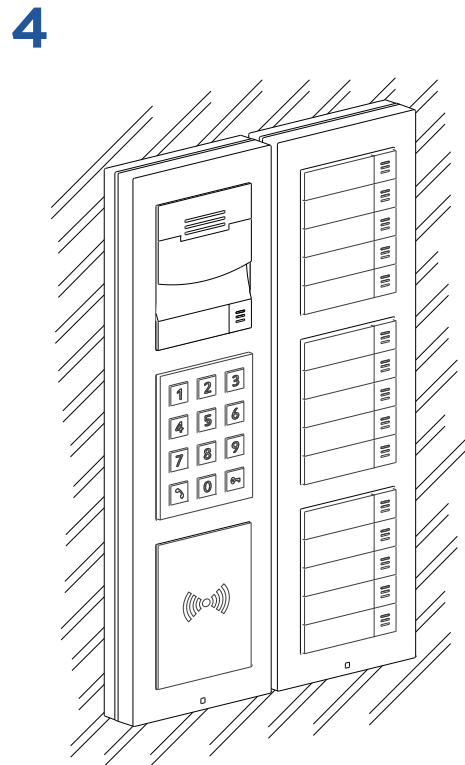
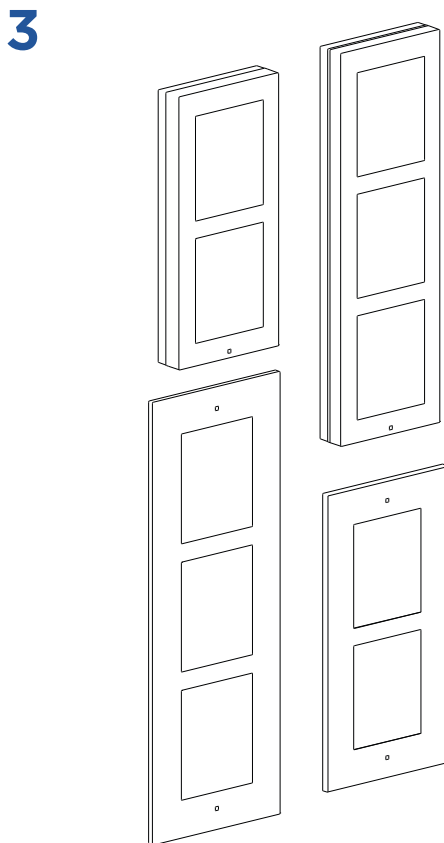
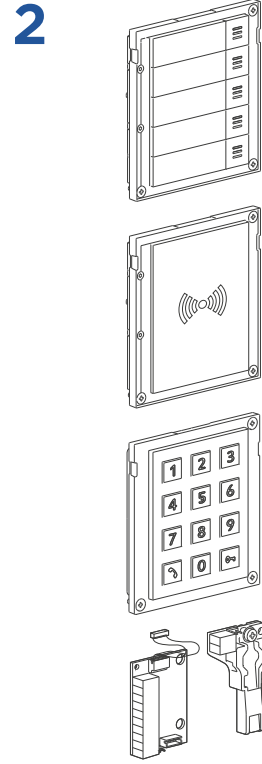
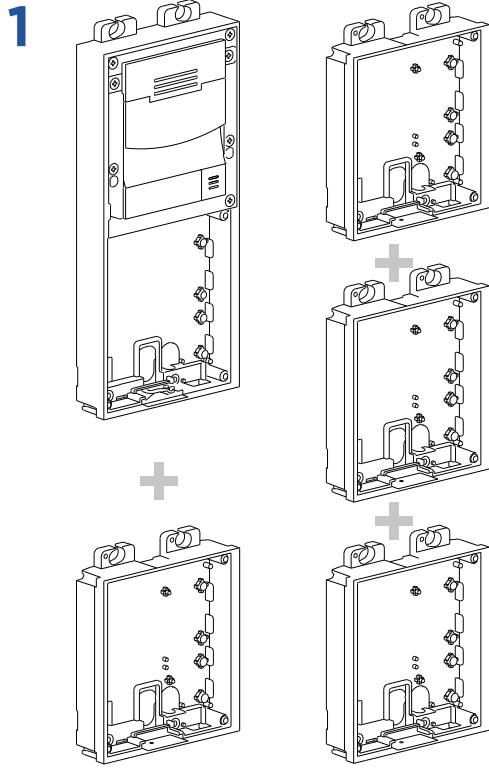

# Modularity

## MODULES



Main unit with camera  
9155101CB  
9155101C



Main unit without camera  
9155101B  
9155101



Infopanel  
9155030



5 buttons  
9155035



Touch Keypad & RFID Reader 125 kHz, 13.56 MHz, NFC  
9155081  
9155083 (secure)



Bluetooth & RFID Reader 125 kHz, 13.56 MHz, NFC  
9155082  
9155082 (secure)



RFID card reader 13,56 MHz 125 kHz  
9155033  
9155032



RFID card reader 13,56 MHz NFC  
9155040  
9155042 (secure)



Fingerprint reader  
9155045



Keypad  
9155031B  
9155031

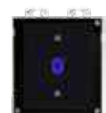

Bluetooth Reader  
9155046



Touchscreen  
9155036



Touch Keypad  
9155047



Induction loop  
9155041



Blind Panel  
9155039



Wiegand  
9155037



Tamper switch  
9155038



I/O  
9155034

## FRAMES



Flush installation 1 module  
9155011B  
9155011



Flush installation 2 modules  
9155012B  
9155012



Flush installation 3 modules  
9155013B  
9155013



Surface installation 1 module  
9155021B  
9155021



Surface installation 2 modules  
9155022B  
9155022



Surface installation 3 modules  
9155023B  
9155023

● Black version  
● Nickel version

## ACCESSORIES

### Boxes

Flush-mounting box for 1 module	9155014
Flush-mounting box for 2 modules	9155015
Flush-mounting box for 3 modules	9155016

### Other

Extension cable - 1 m long	9155050
Blind button	9155051
Nametag foil	9155052

### Backplates

Backplate - 1 module	9155061
Backplate - 2 modules	9155062
Backplate - 3 modules	9155063
Backplate - 2(w) x 2(h) modules	9155064
Backplate - 3(w) x 2(h) modules	9155065
Backplate - 2(w) x 3(h) modules	9155066
Backplate - 3(w) x 3(h) modules	9155067